

YCZF6 Self-recovery

Overvoltage and undervoltage
protector

OPERATION INSTRUCTION

Standard: JB/T 12762-2015

CNC

Deliver
Power For Better Life



Before installing and using this product,
please read this manual carefully and
pay more attention to safety.

YCZF6 Self-recovery Overvoltage and undervoltage protector

1 General

Self-recovery overvoltage and undervoltage protector is a new type of intelligent protection apparatus. With the modular standard design, in case of The protector can quickly and safely break the circuit under continuous high voltage surge in case of overvoltage or undervoltage of power supply line with its modular standard design, avoiding the accident caused by; when voltage resumes normal value, the protector will automatically close the circuit within the specified time to ensure the terminal apparatus can operate normally in an unattended way.

Self-recovery overvoltage and undervoltage protector is applied for the users or loads of AC 230V, 50Hz and rated operating current and below. It is mainly used in the household distribution box or other distribution line requiring protection.

2 Operating conditions

2.1 Ambient temperature: $-35^{\circ}\sim 70^{\circ}\text{C}$

2.2 Altitude: $\leq 3000\text{M}$

2.3 Atmospheric conditions: The atmospheric relative humidity is not more than 50% when

the ambient air temperature is +40°C; high relative humidity is permitted under low temperature, For example, it may be up to 90% at +20°C; special measures should be taken in case of occasional condensation due to temperature variation;

2.4 Pollution degree: level 2;

2.5 Mounting category: category II or III.

2.6 Mounting form: It is installed by using the TH35-7.5 section steel mounting rail.

The inclination of installing surface cannot exceed 5°.

3 Type designation

YC ZF 6 - □ / □

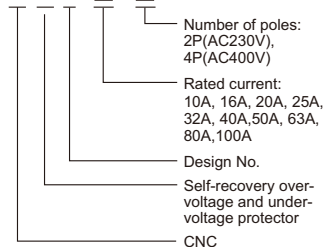

4 Main technical data

- 4.1 Operating power: AC230V50Hz,AC380v (three-phasefour-wire)
- 4.2 Maximum current through: 20A, 32A, 40A, 50A, 63A, 80A, 100A (resistive)
- 4.3 Maximum load power: 4.4k VA, 6.6kVA, 8.8kVA, 11kVA, 13kVA, 17kVA
- 4.4 Overvoltage action cutoff value: AC275V±5V
- 4.5 Overvoltage recovery value: AC255V±5V
- 4.6 Undervoltage action cutoff value: AC175V±5V
- 4.7 Undervoltage recovery value: AC185V±5V
- 4.8 Power transmission delay after power failure: ≤60S
- 4.9 Action delay value: no more than 1 second
- 4.10Installation method: 35mm rail11.Electrical life: 1×10^5

5 Instructions

- 5.1 Wire the product identification input (IN) and output (OUT)correctly. (The load power should be less than the rated power of the product)
- 5.2 The two LEDs on the product panel indicate the status: the power is turned on, the power indicator (green) is on, the protection indicator (red) is off when the power is normally supplied, and the protection indicator (red) is on when the

protection is in the protection state. Start, cut off the load power.

6 Wiring diagram

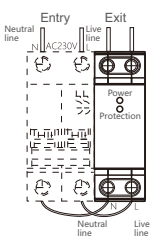

Bottom Entry and Upper Exit Connection Diagram

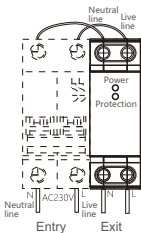

Upper Entry and Bottom Exit Connection Diagram

7 Overall and mounting dimensions(mm)

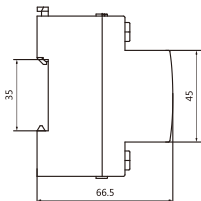
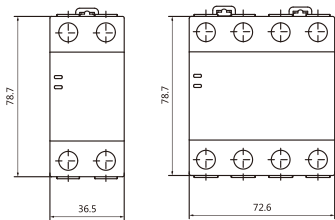



CERTIFICATE

Product Model: YCZF6

Standard: JB/T 12762-2015

Inspector : **CNC003**

Production date: Printed on the product
or package.

This product is qualified according
to the delivery inspection

CNC

YCZF6 series

CNC ELECTRIC

Tel: 0086-577-61989999 Fax: 0086-577-61891122

www.cncele.com E-mail: cncele@cncele.com