

# YCH9-125, YCH9s-125

## Isolating switch

OPERATION INSTRUCTION

Standard: IEC 60947-3

**CNC**

Deliver  
Power For Better Life

 Before installing and using this product, please read this manual carefully and pay more attention to safety.

## **1. General**

YCH9-125, YCH9s-125 Isolating Switch is applicable to the resistive and inductive mixing load with AC 50 Hz/60Hz, rated voltage of no more than 400 V, and rated current up to 125A for on or off(AC-22A), including appropriate overload, used to connect or isolate a circuit from a power supply. The product has opening and closing position indicator function, is especially suitable for effective power isolation during line maintenance to ensure the operation safety of maintenance personnel. Mainly used to be the total terminal electrical appliances switch, also can be used for infrequent control of all kinds of motors, small power electricity apparatus and lighting, etc.

Standard: IEC60947-3

## 2. Operating conditions

2.1 Ambient temperature -5 ~+40

2.2 Altitude: 2000m.

2.3 Air conditions: At mounting site, relative humidity not exceed 50% at the maximum temperature of +40 . For the wettest month, the maximum relative humidity averaged shall be 90% while the lowest temperature averaged in that month is +20 ,special measures should be taken to occurrence of condensation.

2.4 Utilization category is AC-22A.

2.5 Pollution grade: 2

## 3.1 Type designation

YC H 9 - 125

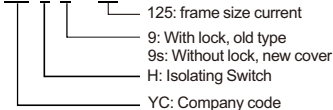

3.2 The basic specifications and main technical parameters of the circuit breaker are shown in Table 1.

Table 1

Rated voltage $U_e$	AC230V, AC400V
Number of poles	1P, 2P, 3P, 4P
Rated current $I_e$	20A, 32A, 40A, 63A, 80A, 100A, 125A
Rated short time withstand current $I_{cw}$	$12I_e$ , 1s
Rated short circuit making capacity $I_{cm}$	$20I_e$ , 0.1s
Rated impulse withstand voltage $U_{imp}$	(1.2/50 $\mu$ s, 2000m) 6kv
Mechanical life (times)	8500
Electrical life (times)	1500

### 3.3 Wire connection

Before installation, check whether technical parameter of the circuit breaker is in conformity with user's requirement.

The conductor of power supply shall be connected to the up terminal of circuit breaker. During installation, the tightening torque is max  $2.5\text{N}\cdot\text{m}$  for 20A 63A, the tightening torque is max  $3.5\text{N}\cdot\text{m}$  for 80A 125A. The sectional area of connecting wire can refer to Table 2.

Table 1

Rated current In A	conductor cross section S mm <sup>2</sup>
20	2.5
32	6
40	10
63	16
80	25
100	35
125	50

#### 4. Overall and mounting dimensions

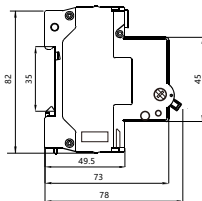
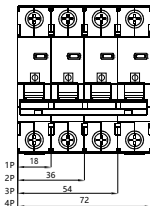

## 5. Ordering instruction

5.1 When ordering, the customer shall indicate the product type, rated current, number of poles and quantity of the circuit breaker. For example: YCH9-125,YCH9s-125 32 3P 880pcs.

5.2 Special requirements of customers can be negotiated separately.



## CERTIFICATE

Product Model: YCH9-125, YCH9s-125

Standard: IEC 60947-3

Inspector: CNC 001

Production date: Printed on the product  
or package.

This product is qualified according  
to the delivery inspection

**CNC ELECTRIC**

Tel: 0086-577-61989999 Fax: 0086-577-61891122

[www.cncele.com](http://www.cncele.com) E-mail: [cncele@cncele.com](mailto:cncele@cncele.com)

**CNC**

YCH9-125, YCH9s-125 Series