

Photovoltaic DC Components

YCDPO III Hybrid Energy Storage Inverter



5.5KVA

Battery Optional

1kW=1kVA

Wi-Fi Function

Touch Screen

On&Off Grid



General

Model: 5.5KW

Nominal Voltage: 220/230/240VAC

Frequency Range: 50Hz/60Hz

Touch Display Screen



Features

- Touch screen display
- PV and utility power the load at the same time (can be set)
- Output power factor PF=1.0
- On&Off Grid with energy storage
- Energy generated record, load record, history information and fault record
- Structure with dust filter
- AC charging start and stop time setting
- External Wi-Fi device optional
- Parallel operation up to 9 units
- Connected with battery optional
- Wide PV input range 120-450VDC
- Independent CPU
- MAX PV Array power 5500W
- Solar and Utility supply power to the load When solar power is not sufficient to load
- The CT sensor will monitor the power consumption of the system and will make sure no excess PV power is delivered to the Grid



WiFi

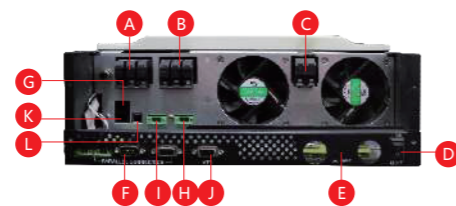

- A AC input
- B AC output
- C PV input
- D ON/OFF switch
- E DC input
- F Parallel connection terminal
- G CAN
- H Generator dry contactor
- I CT
- J Wifi
- K RS232
- L USB

Photovoltaic DC Components

YCDPO III Hybrid Energy Storage Inverter

Hybrid operation

With battery connected

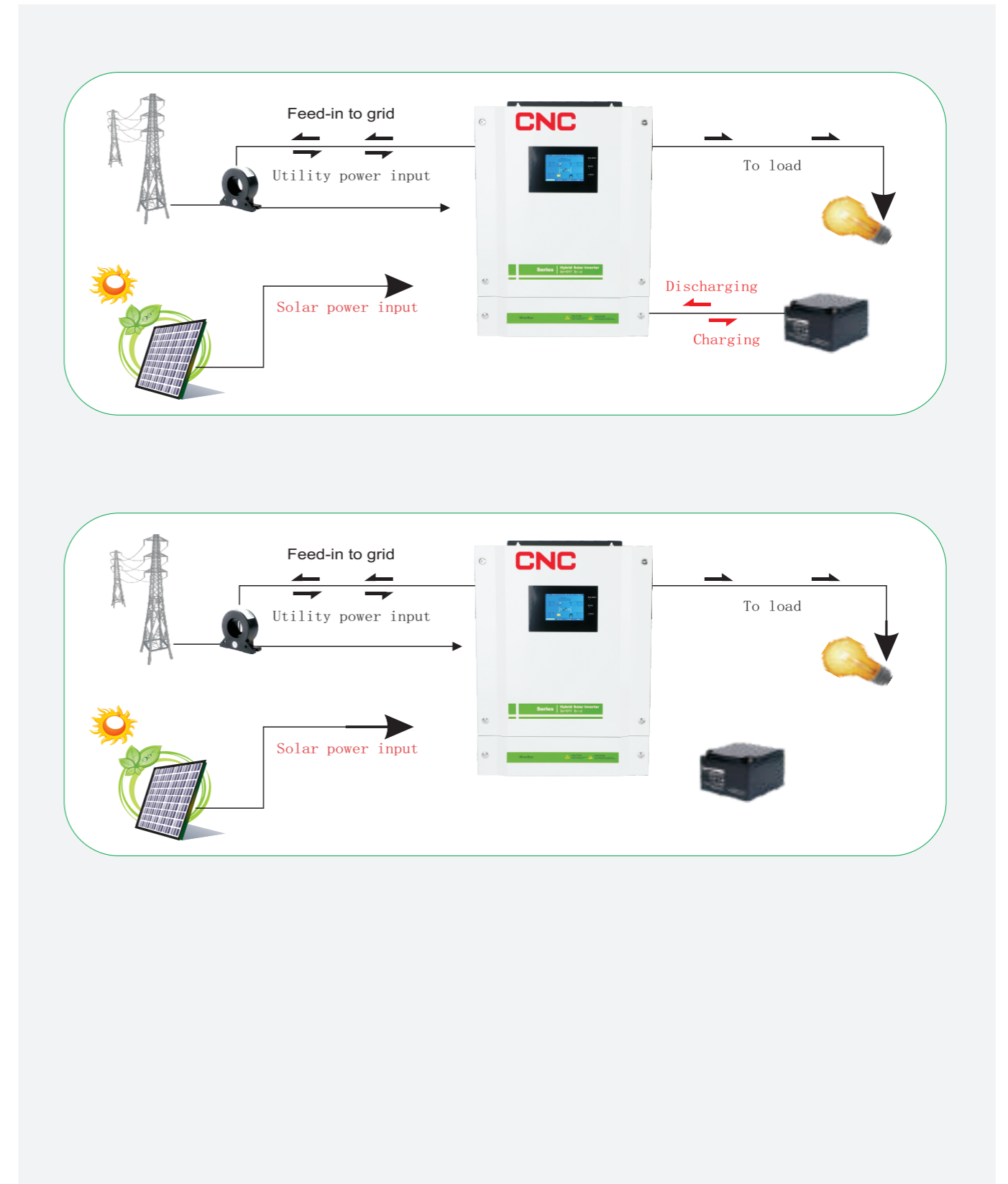

Photovoltaic DC Components

YCDPO III Hybrid Energy Storage Inverter

Single phase output using 9 units(49.5kW)

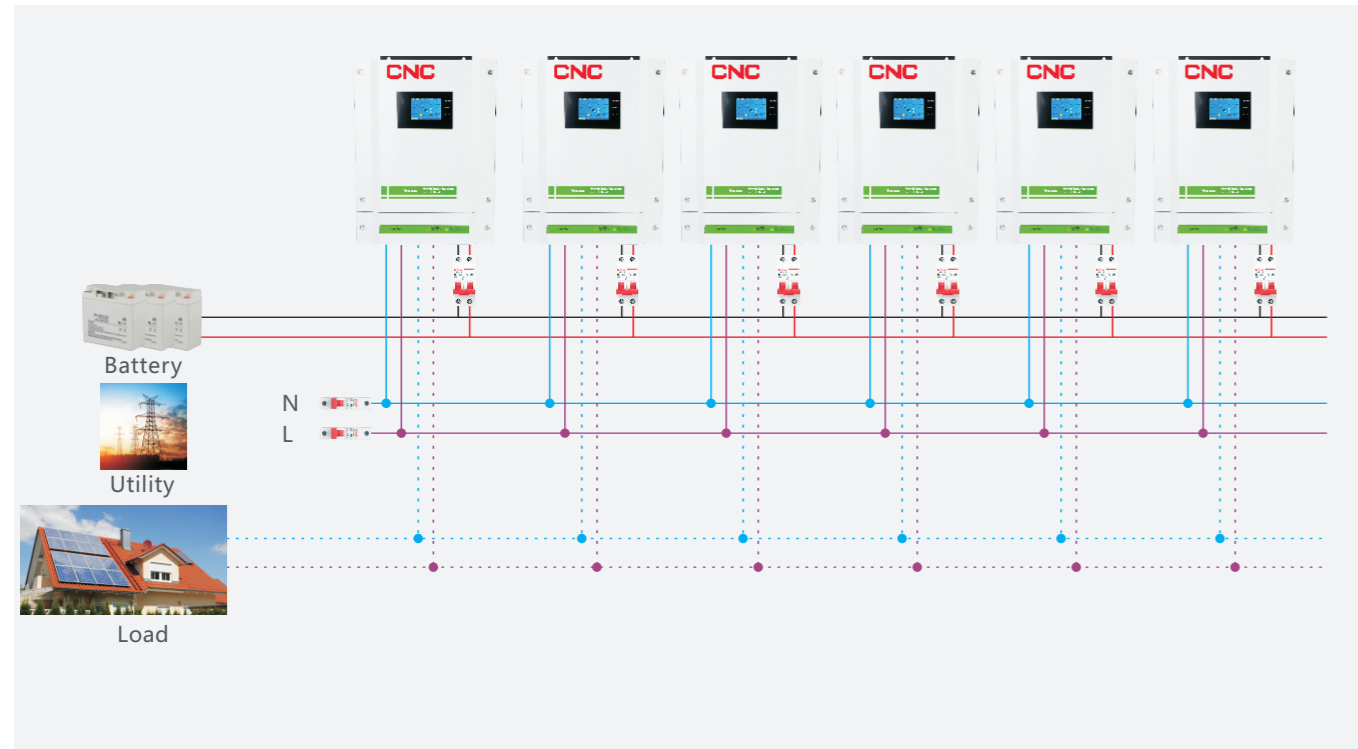

Three phase output using either 3 units(16.5KW)or max 9 units(49.5KW)

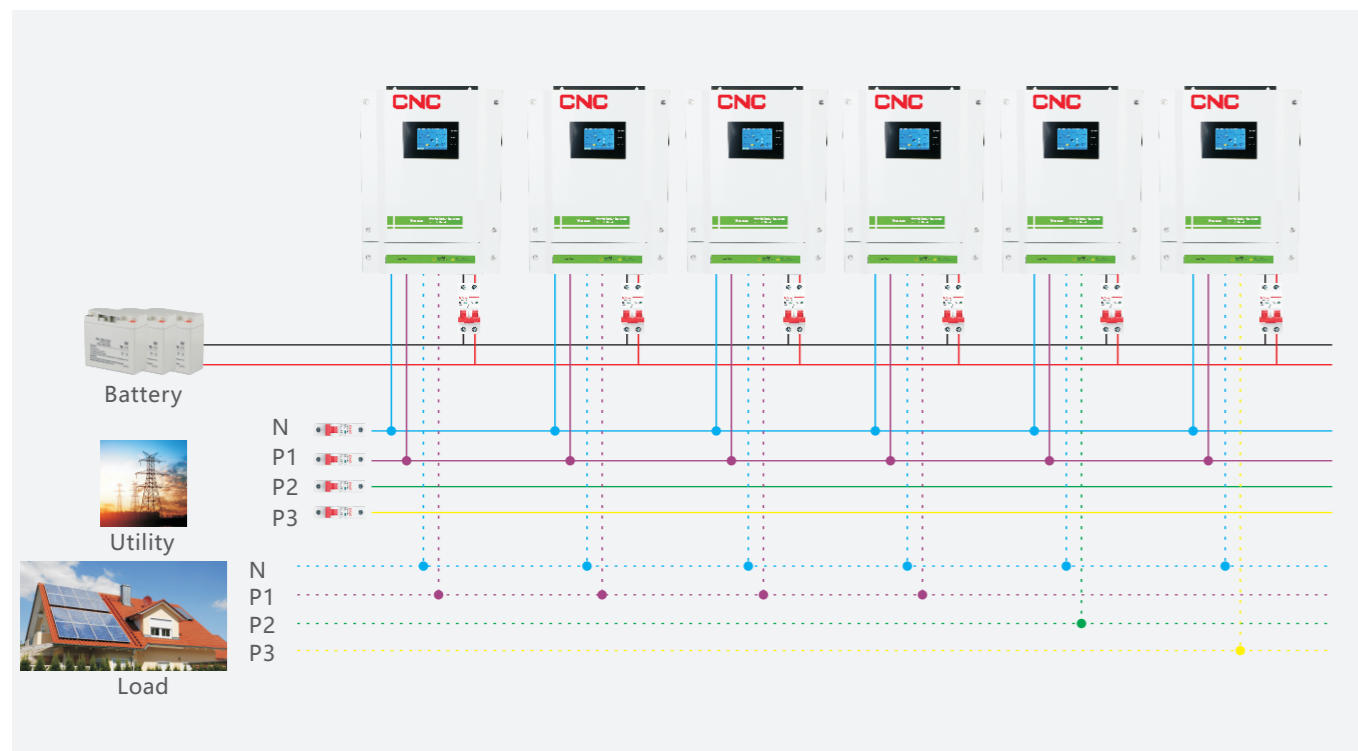

Photovoltaic DC Components

YCDPO III Hybrid Energy Storage Inverter

Wall mounted integrated solar inverter technical specification, built-in MPPT solar controller

Model	YCDPO III 5500-48
Max PV array power	5500W
Rated output power	5500W
Mppt range @ operating voltage	120-450VDC
GRID-TIE Operation	
GRID Output (AC)	
Nominal output voltage	220/230/240VAC
Output voltage range	184-265VAC
Nominal output current	20.5A/19.6A/18.8A
Efficiency	up to 93%
OFF-GRID, Hybrid operation	
GRID Input	
Acceptable input voltage range	120-280VAC or 170-280 VAC
Frequency range	50Hz/60Hz (Auto sensing)
Battery mode output (AC)	
Nominal output voltage	220/230/240VAC
Output wave form	Pure sine wave
Battery & charger	
Nominal DC voltage	48VDC
Maximum AC charge current	60A
Maximum charge current(AC+PV)	90A
Emergency output power	
Maximum output power	5500W
Surge power	11000W
Automatic transfer time	<10ms
General	
Interface	
Parallel function	Yes
Communication	USB or RS232,WIFI, Generator dry-Contact
Environment	
Humidity	0~90% RH (No Condensing)
Operating temperature	0 to 50°C
Net weight(KG)	11.9
Gross weight(KG)	13.1
Dimension (W x D x H)mm	345x476x133.2

Note: Product specifications are subject to change without further notice.