

## Photovoltaic Inverter

# YCDPO-II Off-grid Energy Storage Inverter



### General

YCDPO-II off-grid energy storage inverter, input voltage range to 450V, output AC pure sine wave AC230V 50/60HZ, can drive 1.6~6KW single-phase load.

### Features

1. Pure sine wave MPPT solar inverter Built-in 80/120A MPPT solar charger
2. YCDPO II series is suitable for off-grid and on grid(optional) applications.
3. Battery equalization function extend life cycle Reserved communication port(RS485,-CAN) for BMS
4. High PV input voltage range With touch buttons Two outputs for smart load management (4/6KW OPT)

### Type designation

YCDP II - 4000 / 24

Product name	Rated power(W)	Battery charging voltage
YCDPO II	4000	24
YCDPO II	1600 3200 4000 6000	12 24 48

## Photovoltaic Inverter

# YCDPO-II Off-grid Energy Storage Inverter

### Technical date

Model	YCDPO II-1600-12	YCDPO II-3200-24	YCDPO II-4000-24	YCDPO II-6000-48
Rated Power	1600VA/1600W	3200VA/3200W	4000VA/4000W	6000VA/6000W
<b>AC INPUT</b>				
Nominal Voltage(VAC)	230VAC			
Voltage Range(VAC)	170-280VAC(For Personal Computers);90-280 VAC(For Home Appliances)			
Frequency range(Hz)	50/60Hz(Auto sensing)			
<b>AC OUTPUT</b>				
Surge power (VA)	3200VA	6400VA	8000VA	12000VA
Output voltage(VAC)	230VAC ± 5%			
Rated frequency	50/60Hz			
Efficiency (Peak)	93%			
Transfer time	10ms(For Personal Computers);20ms(For Home Appliances)			
<b>BATTERY</b>				
Battery Voltage(VDC)	12VDC	24VDC	48VDC	
Floating Charge Voltage(VDC)	13.5VDC	27VDC	54VDC	
Overcharge Protection(VDC)	16VDC	33VDC	63VDC	
Battery type	Lithium/Lead-acid			
<b>SOLAR CHARGER &amp; AC CHARGER</b>				
Maximum PV Array Open Voltage(V)	500			
Maximum PV Array Power	2000W	3500W	5000W	7000W
MPPT voltage range(V)	30~450VDC		60~450VDC	
Maximum input current	15A	20A		27A
MPPT tracker/strings	1			
Maximum solar charge current	80A	120A		
Maximum AC charge current	60A	100A		
Maximum charge current	80A	120A		
<b>PROTECTION &amp; FEATURE</b>				
AC overcurrent	Yes			
AC overvoltage	Yes			
Over temperature protection	Yes			
Smart load management	NO		Yes(optional)	
On Grid	Yes (optional)			
<b>ENVIRONMENT</b>				
Operating Temperature	-10°C ~ 50°C			
Humidity	5~90%RH (No Condensing)			
Altitude	(2000m Derating)			
Dimensions DxWxH(mm)	348*270*95		400*300*115	
Net Weight(KG)	5	5.5	8.5	9
<b>COMMUNICATION</b>				
Interface	Standard:RS232,USB; CAN&RS485; Optional:WiFi,Bluetooth			
Safety standard	EN/IEC62109-1,EN/IEC62109-2			

## Photovoltaic Inverter

# YCDPO-II Off-grid Energy Storage Inverter

### Schematic diagram of the product connection

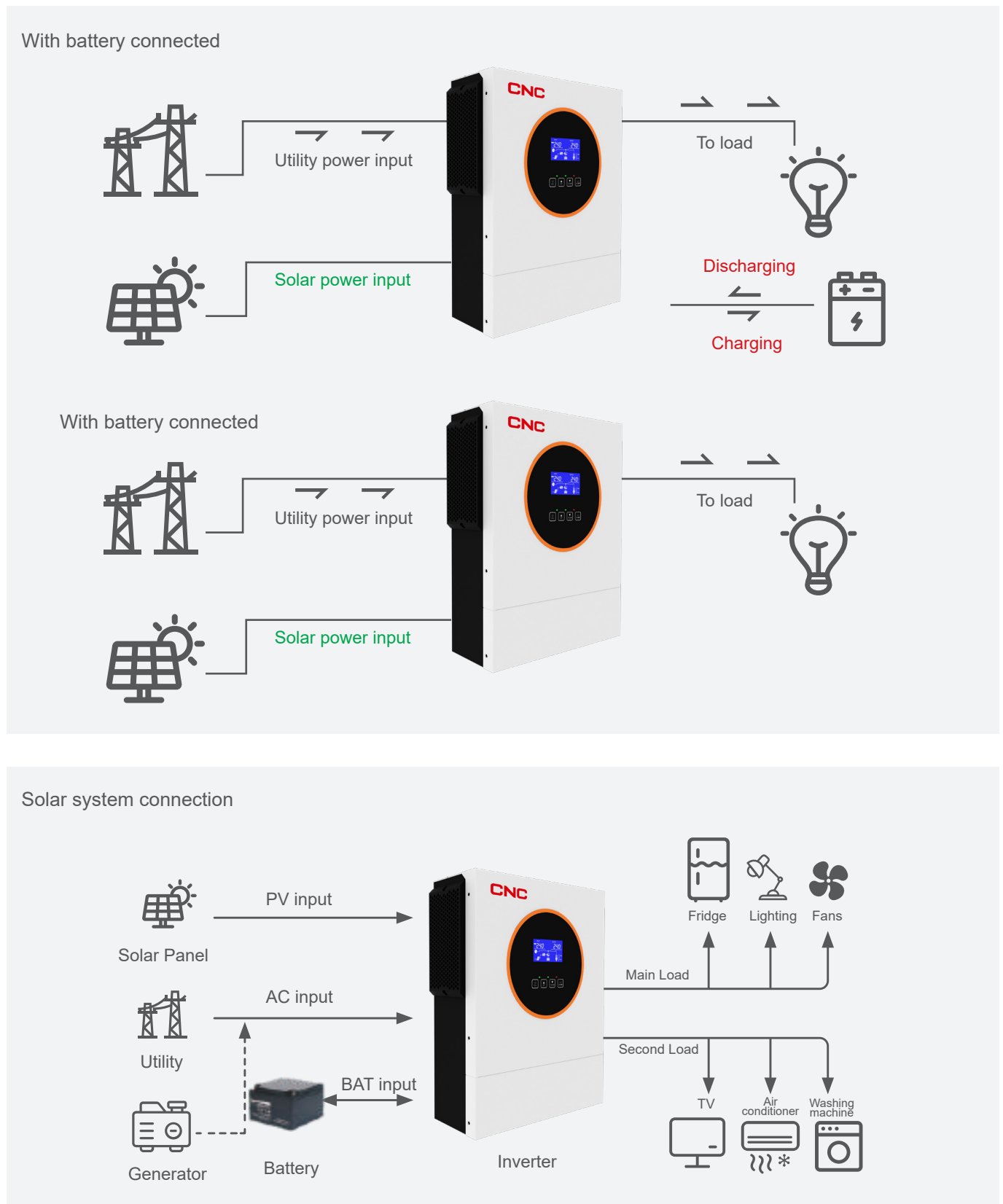

## Photovoltaic Inverter

# YCDPO-II Off-grid Energy Storage Inverter

Schematic diagram

