

## Electrical Accessories

### Non-Insulated Spade Terminals

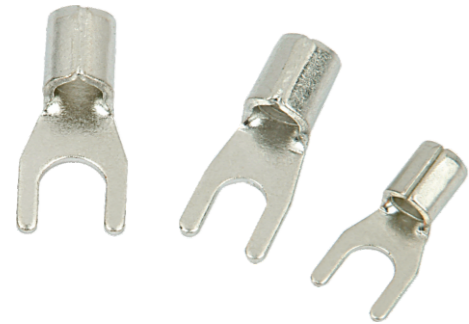

Conductor cross-section: 0.5-1.5mm<sup>2</sup>; American Wire Gauge: 22-16;  
Maximum current: I<sub>max</sub>=19A

Model	US-made bolt number	Size						
		Bolt hole diameter	B	L	F	H	DΦ	dΦ
		d2	mm	mm	mm	mm	mm	mm
SNB1.25-3	#4	3.2mm	5.7	16.0	6.5	4.8	3.4	1.7
SNBS1.25-3.5	#6	3.7mm	5.7	16.0	6.5			
SNBS1.25-4	#8	4.3mm	6.4	16.0	6.5			
SNBM1.25-4	#8	4.3mm	7.2	16.0	6.5			
SNBS1.25-5	#10	5.3mm	8.1	16.0	6.5			
SNBS1.25-6	1/4	6.5mm	9.5	16.0	6.5			

Conductor cross-section: 1.5-2.5mm<sup>2</sup>; American Wire Gauge: 16-14;  
Maximum current: I<sub>max</sub>=27A

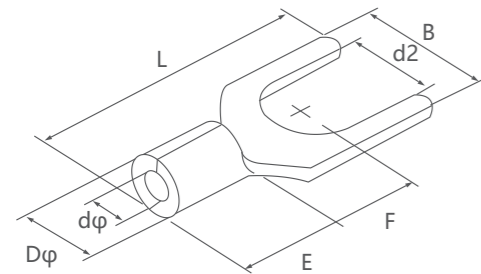

Model	US-made bolt number	Size						
		Bolt hole diameter	B	L	F	H	DΦ	dΦ
		d2	mm	mm	mm	mm	mm	mm
SNB2-3	#4	3.2mm	5.7	16.0	6.5	4.8	4.1	2.3
SNBS2-3.5	#6	3.7mm	5.7	16.0	6.5			
SNB2-4	#8	4.3mm	6.4	16.0	6.5			
SNBM2-4	#8	4.3mm	7.2	16.0	6.5			
SNLS2-5	#10	5.3mm	9.5	16.0	6.5			
SNBS2-6	1/4	6.5mm	9.5	16.0	6.5			
SNBL2-8	1/4	6.5mm	12.0	22.0	11.0			

Conductor cross-section: 2.5-4mm<sup>2</sup>; American Wire Gauge: 14-12;  
Maximum current: I<sub>max</sub>=37A

Model	US-made bolt number	Size						
		Bolt hole diameter	B	L	F	H	DΦ	dΦ
		d2	mm	mm	mm	mm	mm	mm
SNB3.5-4	#8	4.3mm	8.0	18.3	7.0	6.0	5.0	3.0
SNB3.5-5	#10	5.3mm	8.0	18.3	7.0			
SNB3.5-6	1/4	6.5mm	12.0	21.5	12.1			

Conductor cross-section: 4-6mm<sup>2</sup>; American Wire Gauge: 12-10;  
Maximum current: I<sub>max</sub>=48A

Model	US-made bolt number	Size						
		Bolt hole diameter	B	L	F	H	DΦ	dΦ
		d2	mm	mm	mm	mm	mm	mm
SNBS5.5-4	#8	4.3mm	8.3	19.5	7.5	6.8	5.6	3.4
SNBS5.5-5	#10	5.3mm	9.0	19.5	7.7			
SNBS5.5-6	1/4	6.5mm	9.0	19.5	7.5			