

## Modular DIN Rail

### YCB8RL-63 RCCB Electromagnetic

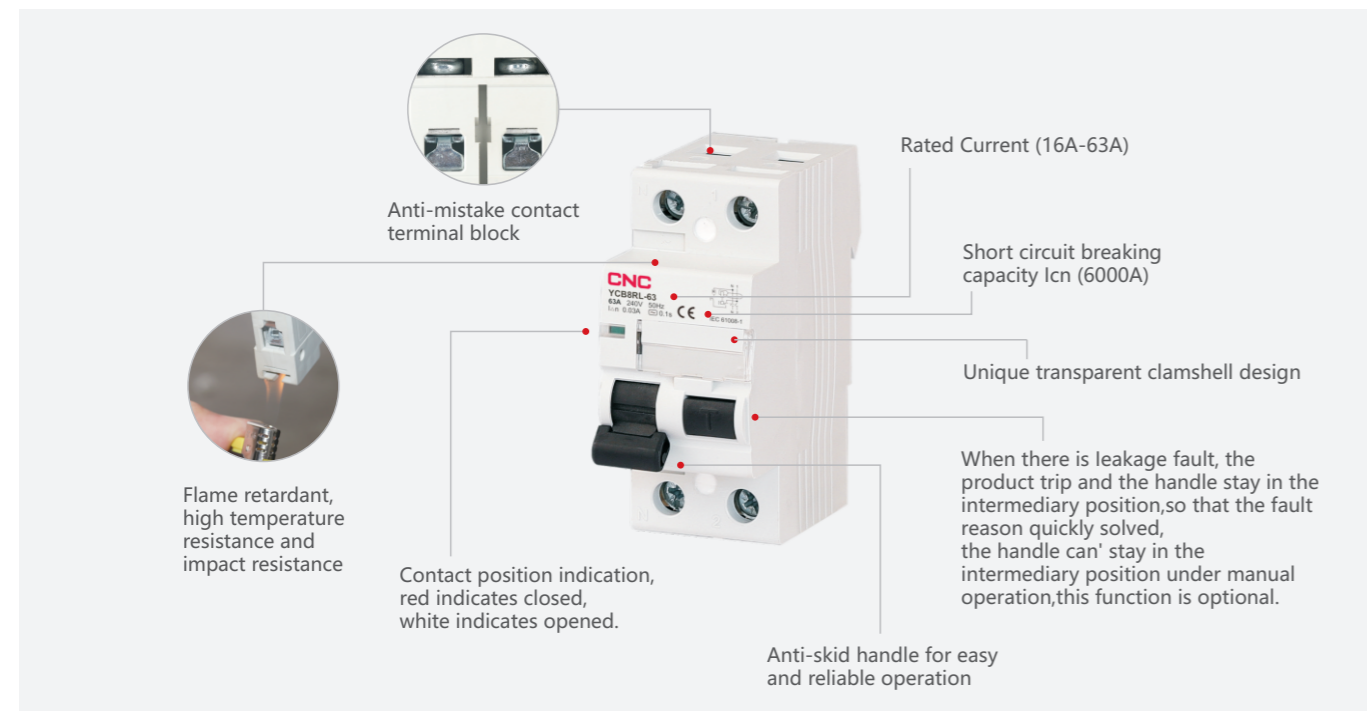

#### General

1. Protection against the effects of sinusoidal alternating earth fault currents
2. Protection against indirect contacts and additional protection against direct contacts
3. Protection against fire hazard caused by insulation faults
4. Controlling and Switching
5. Used in residential building, non-residential building, energy sources, industry and infrastructure

#### Release

Type		Tripping sensitivity data	
AC	For residual sinusoidal alternating currents	30mA	For personnel, material and fire protection, as well as for protection against direct contact
A	For residual sinusoidal alternating currents and residual pulsating direct currents	100mA	For providing protection against indirect contacts
		300mA	For providing fire protection in case of insulation faults

#### Wiring Diagram

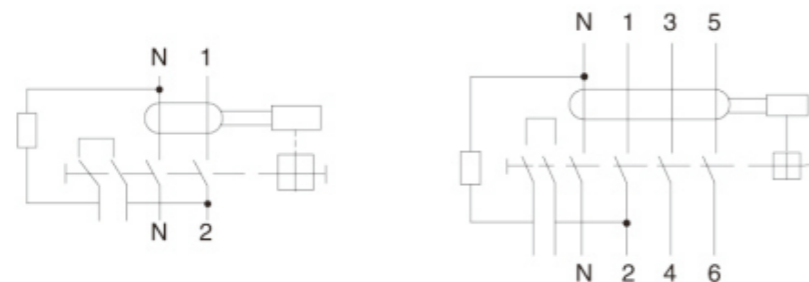

## Modular DIN Rail

### YCB8RL-63 RCCB Electromagnetic

#### Specifications

Type	Standard	IEC/EN 61008-1	
Electrical features	Leakage type	Electromagnetic type	
	Rated current $I_n$	A	16, 25, 32, 40, 50, 63
	Type (wave form of the earth leakage sensed)		A, AC
	Poles	P	2, 4
	Rated voltage $U_e$	V	230/400
	Insulation voltage $U_i$	V	500
	Rated frequency	Hz	50/60
	Rated breaking capacity $I_{nc}=I_{\Delta c}$	A	6000
	Rated impulse withstand voltage (1.2/50) $U_{imp}$	V	6000
	Dielectric test voltage at ind. Freq. for 1min	kV	2.5
	Rated sensitivity $I_{\Delta n}$	A	0.03, 0.1, 0.3
	Rated residual making and breaking capacity $I_{\Delta m}$	A	500( $I_n \leq 40A$ ); 630( $I_n = 50A/63A$ )
	Pollution degree		2
Mechanical features	Electrical life	t	4000
	Mechanical life	t	8000
	Protection degree		IP20
	Storage temperature	°C	-25~+70
	Ambient temperature (with daily average $\leq 35^\circ\text{C}$ )	°C	-5~+40
Installation	Terminal connection type		Cable/Pin-type busbar/U-type busbar
	Terminal size top / bottom for cable	mm <sup>2</sup>	25
		AWG	18-3
	Terminal size top / bottom for busbar	mm <sup>2</sup>	10
		AWG	18-8
	Tightening torque	N*m	2.5
		In-lbs	22
Mounting		On DIN rail EN 60715(35.5mm)by means of fast clip device	
Connection		From top and bottom	

#### Overall and mounting dimensions(mm)

