

## CJ19i(CJ19s) Contactor

### Product Structure



**Opening design**  
It's convenient for customers to tighten and loosen screws at any time.

**Unique slider design**

- Turn tedious into simplicity, improve the efficiency of installation and disassembly.
- Realize tool-free installation and disassembly.
- The original tedious disassembly becomes very simply.

**Fire resistance shell**  
High temperature resistance, corrosion resistance, safety and security.

**Dust prevention**  
Add dust proof sticker, easy to deal with dusty environment, intimate care.

**Integrated signage, difficult to fall off.**

**Pure copper coils**  
Automatic winding, enamelled wire above QA-180

**Customized silicon steel sheet**  
DW600, big iron core, actuate more smoothly.

**Silver alloy contact**  
Stronger electrical conductivity, more sensitive, not easy oxidation.

## CJ19i(CJ19s) Contactor

### General

CJ19i contactor for capacitor switching (hereinafter called contactor) is suitable for the circuit of AC 50Hz/60Hz with rated voltage up to 690V. It is mainly used to add low voltage reactive power compensation equipment or cut off low voltage parallel capacitor. The contactor is equipped with a device to suppress the inrush current, which can effectively reduce the impact of the making inrush current on the capacitor and suppress the over-voltage when the capacitor is cut off.  
Standard: IEC/EN 60947-4-1.

### Type designation

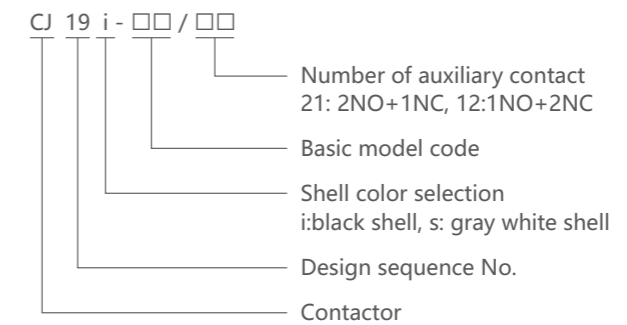

### Operation conditions

- Ambient temperature: -5°C~+40°C, the average during 24 hours should not exceed +35°C;
- Altitude: ≤2000m;
- Atmosphere conditions: At mounting site, relative humidity not exceed 50% at the max temperature of +40°C, higher relative humidity is allowable under lower temperature. For example, RH could be 90% at +20°C, special measures should be taken to occurrence of condensation;
- Pollution degree: 3
- Installation category: III
- Installation conditions: the inclination between installation plane and vertical plane is within ±5°
- Impact and shake: the products should locate in the places where there are no obvious impact and shake.

## CJ19i(CJ19s) Contactor

### Technical data

Contactor model		CJ19i-25 CJ19s-25	CJ19i-32 CJ19s-32	CJ19i-43 CJ19s-43	CJ19i-63 CJ19s-63	CJ19i-95 CJ19s-95	CJ19i-115 CJ19s-115
Main circuit features							
Rated operational voltage(Ue)	V	380/400					
Rated isolation voltage(Ui)	V	690					
Rated current of controllable capacitor(In)	AC-6b 400V A	17	29	36	43	72	87
Rated capacity of controllable capacitor(Qn)	AC-6b 230V kVar	6	9	10	15	22.5	35
	AC-6b 400V kVar	12	18	20	30	45	60
Rated conventional heating current(Ith)	A	25	32	43	63	95	115
Restrained surge capacity	A	≤35In			≤55In		
Mechanical durability	10 <sup>4</sup> times	100					
Electrical durability	AC-6b 400V 10 <sup>4</sup> times	15				12	
Operating frequency cycles/h	AC-6b 400V times/h	300				120	
Coil features							
Controlled power voltage (Us)	AC50Hz V	110, 220, 380					
Operation voltage range	operation voltage V	85%~110%Us when install inclination angle is +22.5°; 70%~120%Us when install inclination angle is ±5°;					
	release voltage V	20%~75%Us when install inclination angle is +22.5°; 20%~65%Us when install inclination angle is ±5°;					
Auxiliary contact features							
Number of auxiliary contact		12, 21					
Rated conventional heating current(Ith)	A	10					
The minimum load can be connected to		6V×10mA					

## CJ19i(CJ19s) Contactor

### Overall and mounting dimensions

CJ19i(CJ19s)-25, 32, 43

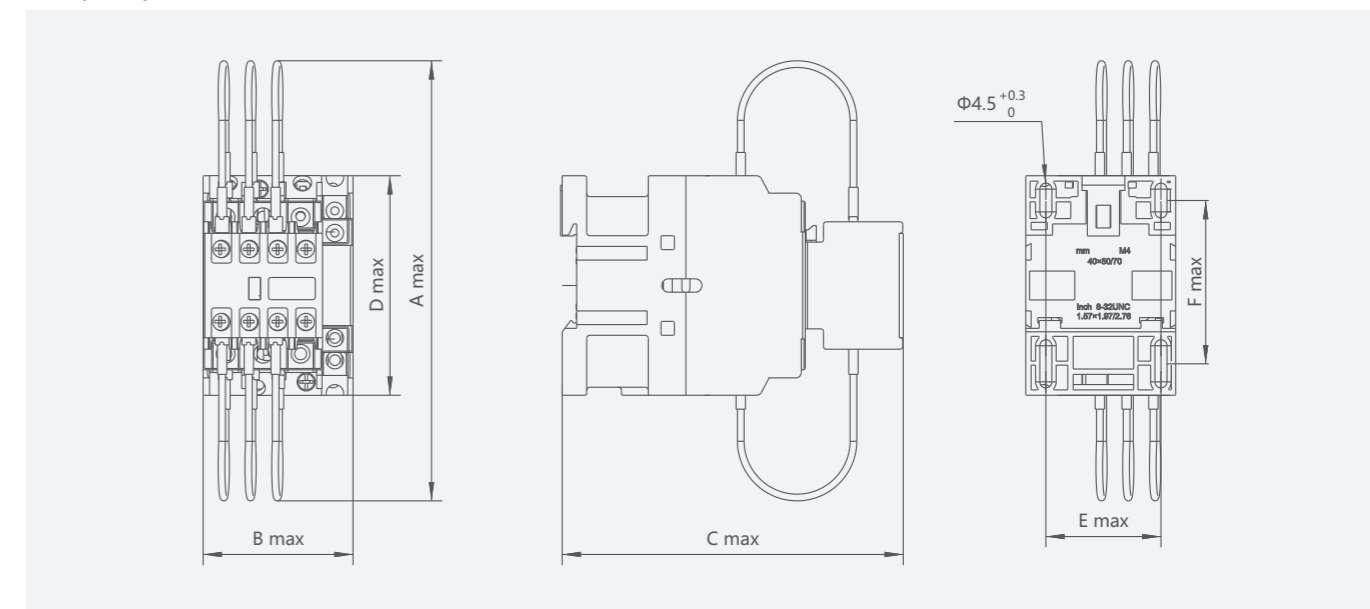

CJ19i(CJ19s)-25, 32, 43

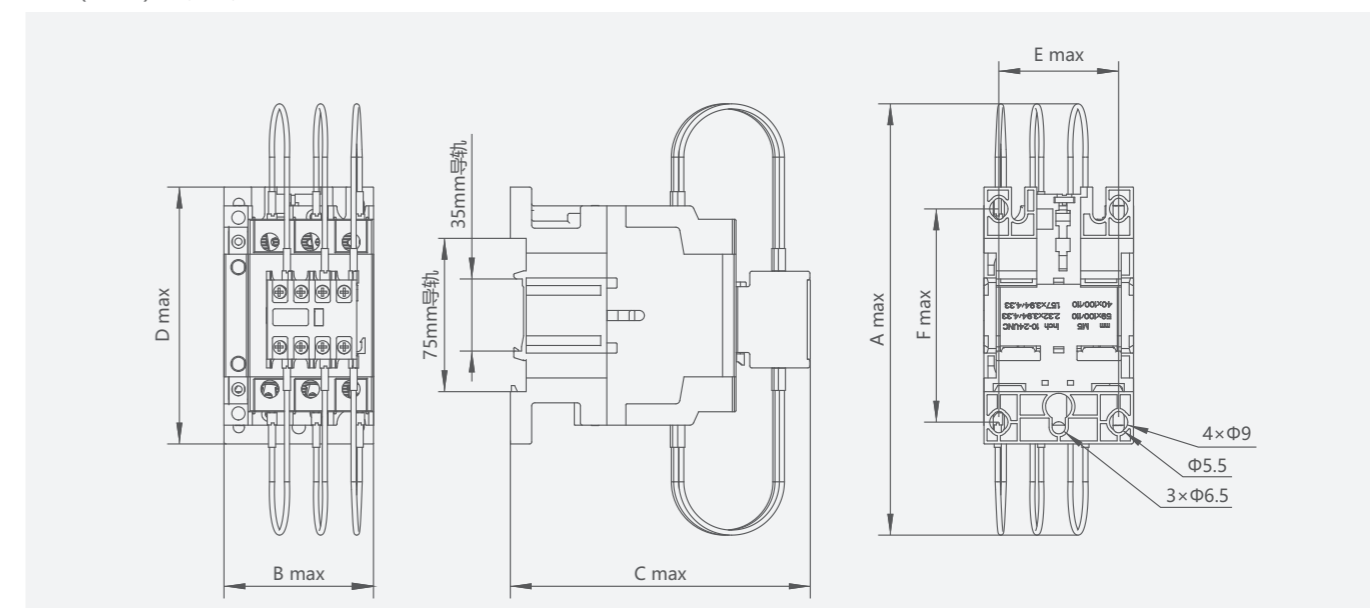

Model	overall dimensions				mounting dimensions	
	Amax	Bmax	Cmax	Dmax	Emax	Fmax
CJ19i(CJ19s)-25	176	45.5	122	74.5	35	50/60
CJ19i(CJ19s)-32	180	56.5	132	83	40	50/60
CJ19i(CJ19s)-43	180	56.5	132	83	40	50/60
CJ19i(CJ19s)-63	190	74.5	154	127.5	59	100/110
CJ19i(CJ19s)-95	190	85.5	160	127.5	67	100/110
CJ19i(CJ19s)-115	190	85.5	160	127.5	67	100/110